

B120T

Le B120T a été spécialement conçu pour fonctionner dans des applications de chauffage et industrielles exigeantes, généralement des applications eau-eau et des refroidisseurs d'huile. Ce produit a contribué à l'échange rapide des échangeurs de chaleur traditionnels à plaques et joint, ou à calandre en faveur des BPHE. Il est largement utilisé comme condenseur dans des applications de climatisation et de réfrigération.



Spécifications de base

Nombre de plaques max. (NoP)	250
Débit volumétrique max.	27,4 m ³ /h (17.61 gpm)
Volume du canal	0.241/0.241 dm ³ (0.0085/0.0085 ft ³)
Matières	Plaques en acier inoxydable 316, brasage cuivre
Poids sans les connexions	8.33+(0.404*NoP) kg 18.36+(0.891*NoP) lb

Les dimensions standard

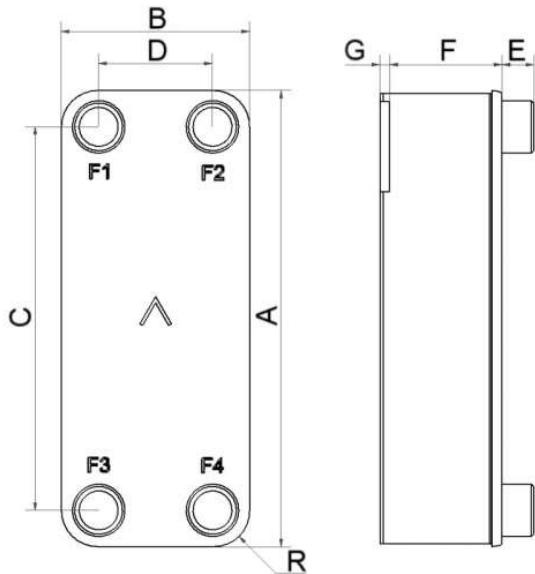

#	MM	IN
A	525	20.67
B	243	9.57
C	456	17.95
D	174	6.85
F	10.00+2.29*(NoP)	0.39+0.09*(NoP)
G	4	0.16
R	35	1.38
E_1	27	1.06

PED pression / température

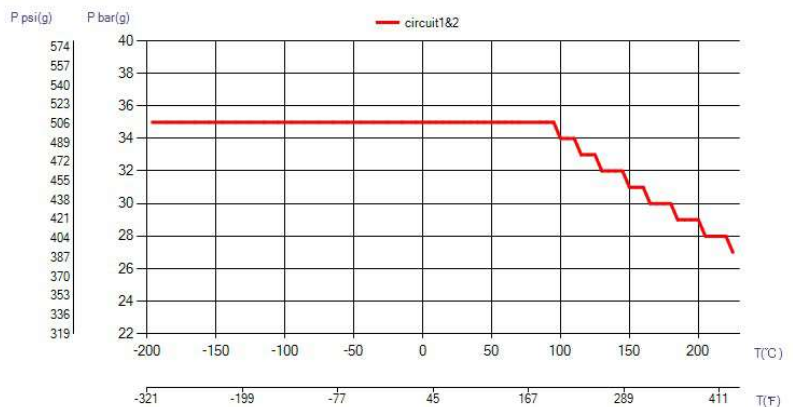

AXINTRA

ÉCHANGEURS THERMIQUES

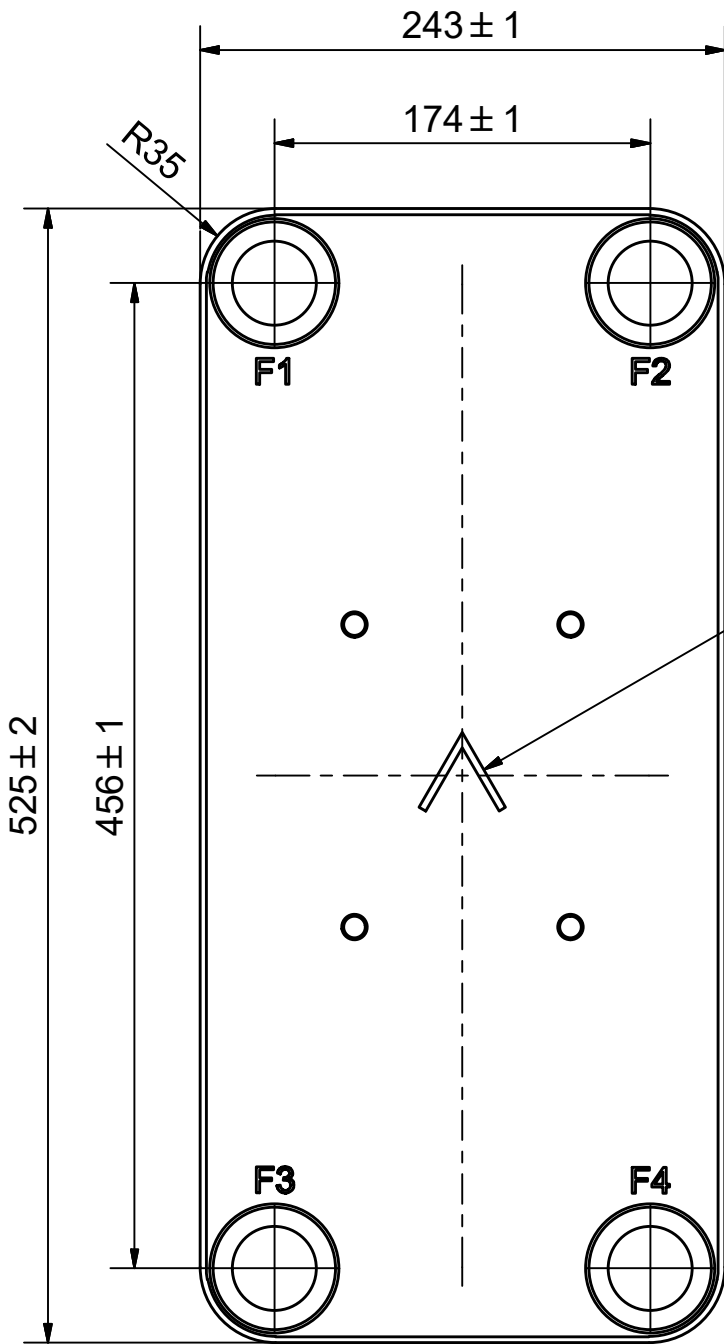

NOTE 1

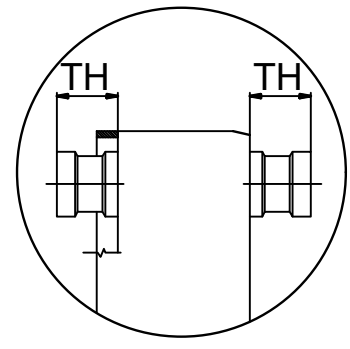
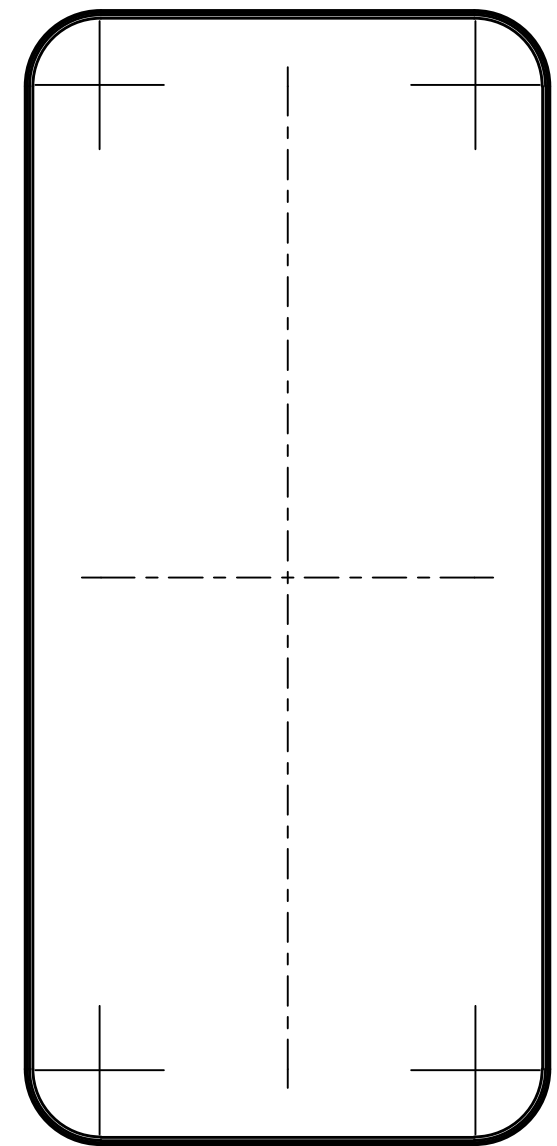
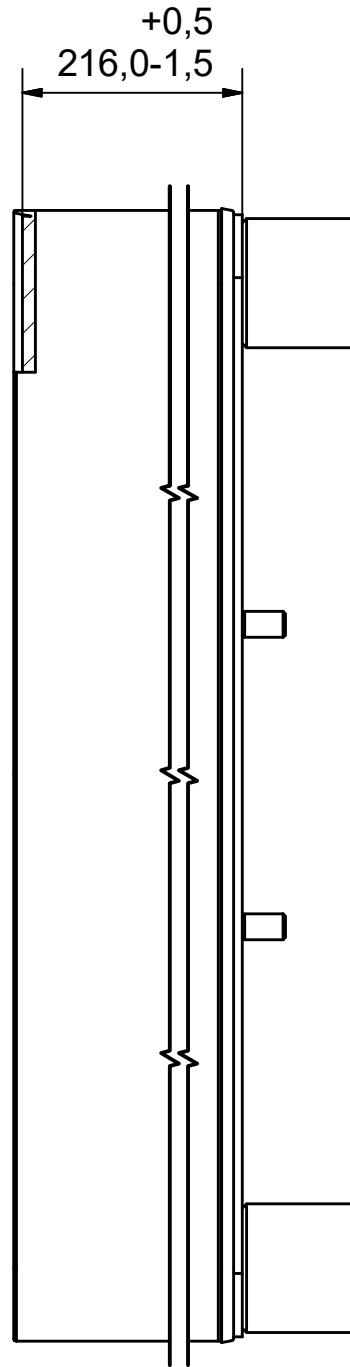

ÉCHANGEURS THERMIQUES

F4	45134	ISO-G 2", TH = 54.2	CD000041
F3	45134	ISO-G 2", TH = 54.2	CD000041
F2	45134	ISO-G 2", TH = 54.2	CD000041
F1	45134	ISO-G 2", TH = 54.2	CD000041
F	21118	B120T/50 BOLT LOC F 4x C140x100	CG450024_1

NOTE 1 ALTERNATE MARKING: STICKER OR STAMP

Pos	Article No	Title / Denomination, code, material, dimension etc	Drawing No./ref	Pos	Article No	Title / Denomination, code, material, dimension etc	Drawing No./ref
-----	------------	---	-----------------	-----	------------	---	-----------------

Title		B120TH/1P-SC-S	
 A DOVER COMPANY	Created Date	6/23/2021	Created By
	Article/Configuration number	13975-090	Drawing number
			AU
			AU00644530_13975-090

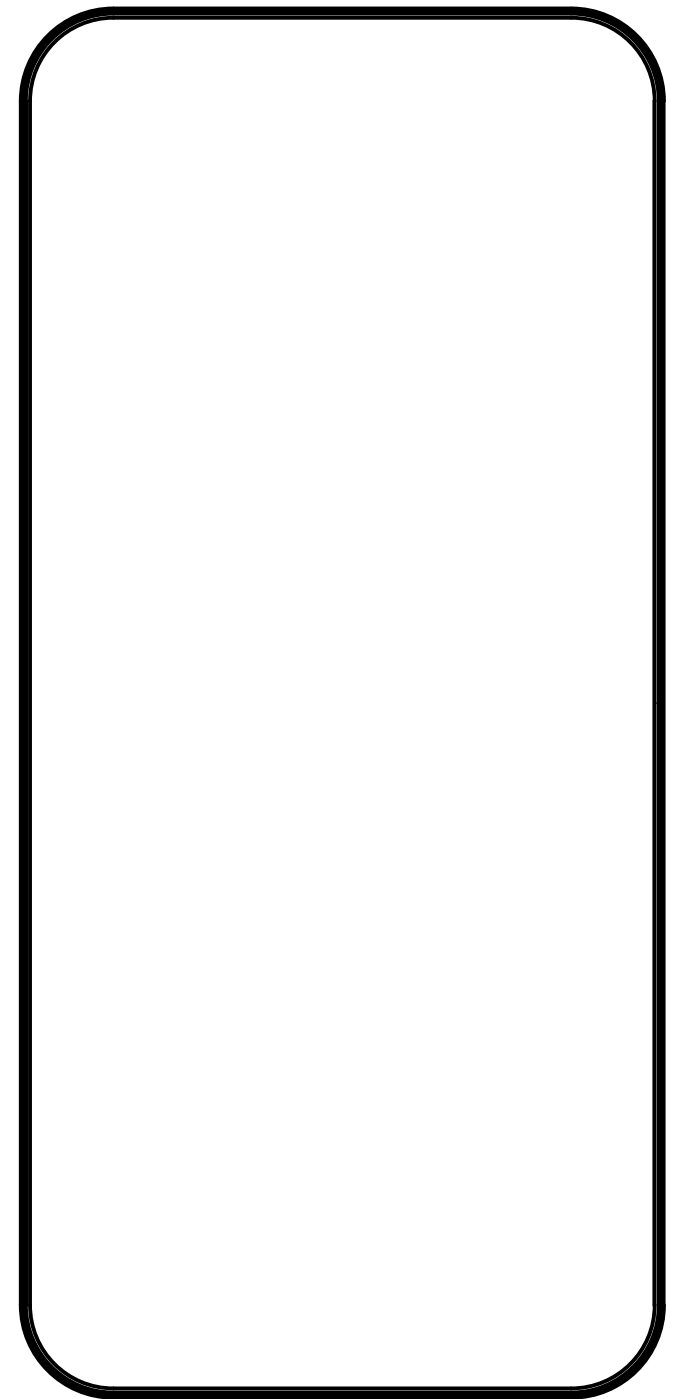
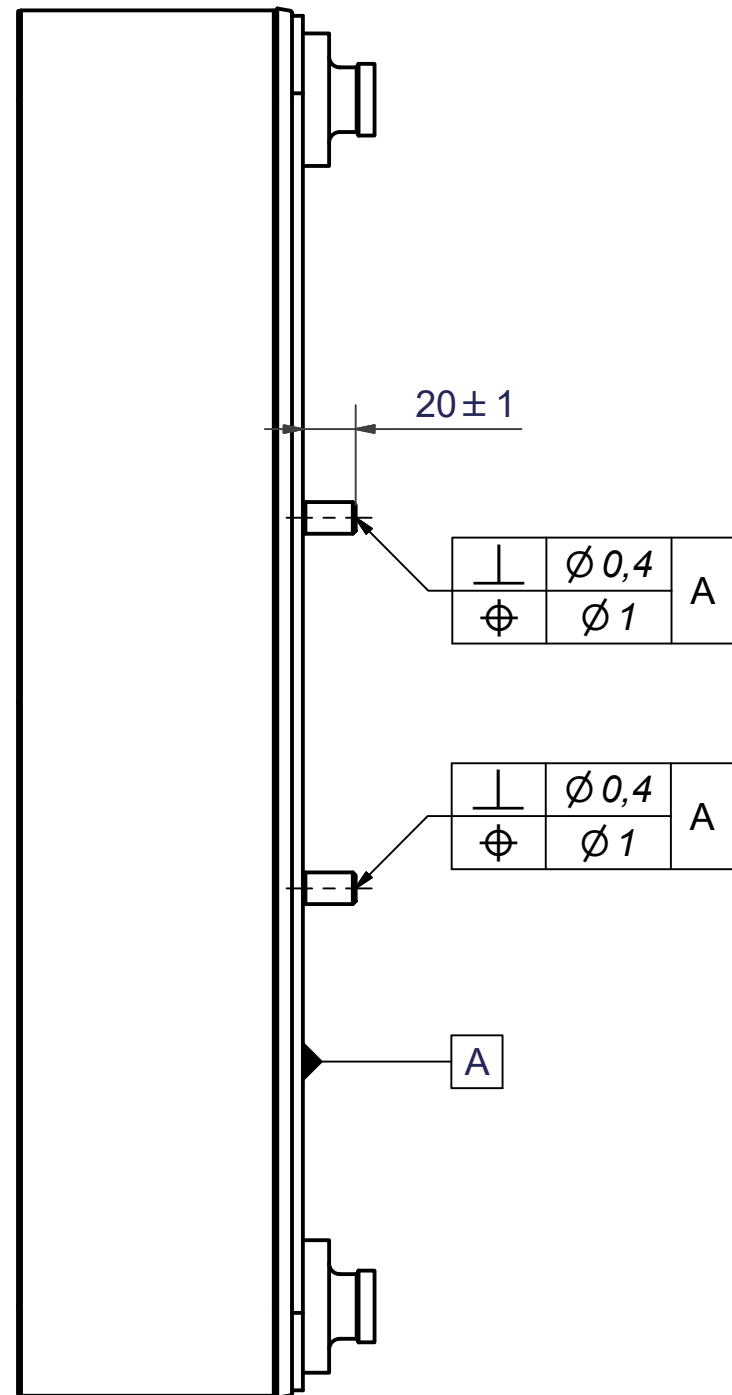
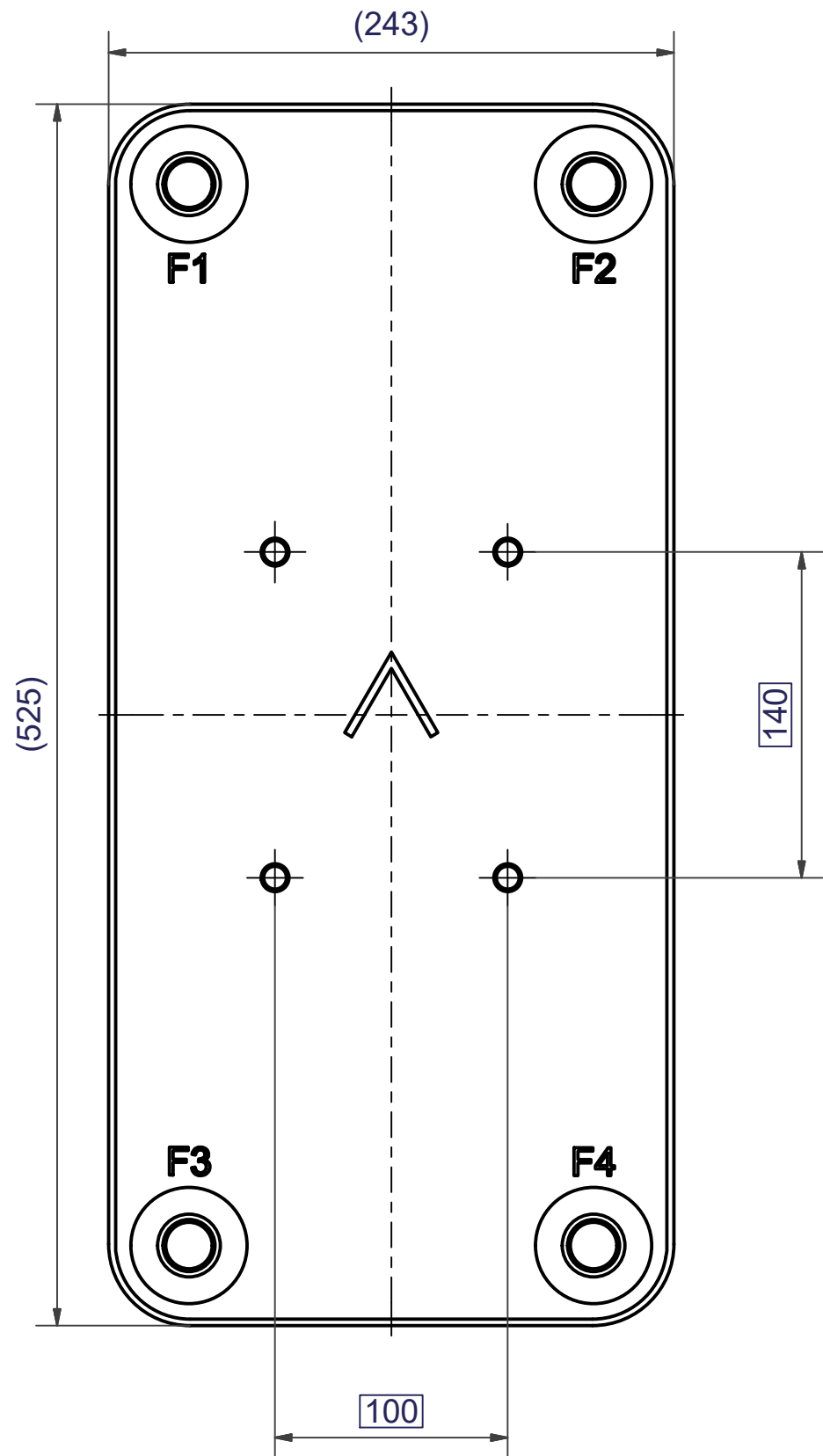

1	4	STUD BOLT M12x20 ART. NO. 45095	M12x20
IT	QTY	DESCRIPTION	Drawing No./Ref
lathe	PDM	PDM	2004-10-12
		General geometrical tolerancing ISO 2768: m	General surface finish R _a : 3.2
		1:1	
		B120T/50 BOLT LOC F 4x C140x100	
Article number 21118		Drawing number CG450024	
		Revision 00	
		Sheet 1 (1)	

Rev No	Alteration	Date	Checked	Approved
05	Added 320 size to NOTE 1.	2018-06-12	SKDS	PDM

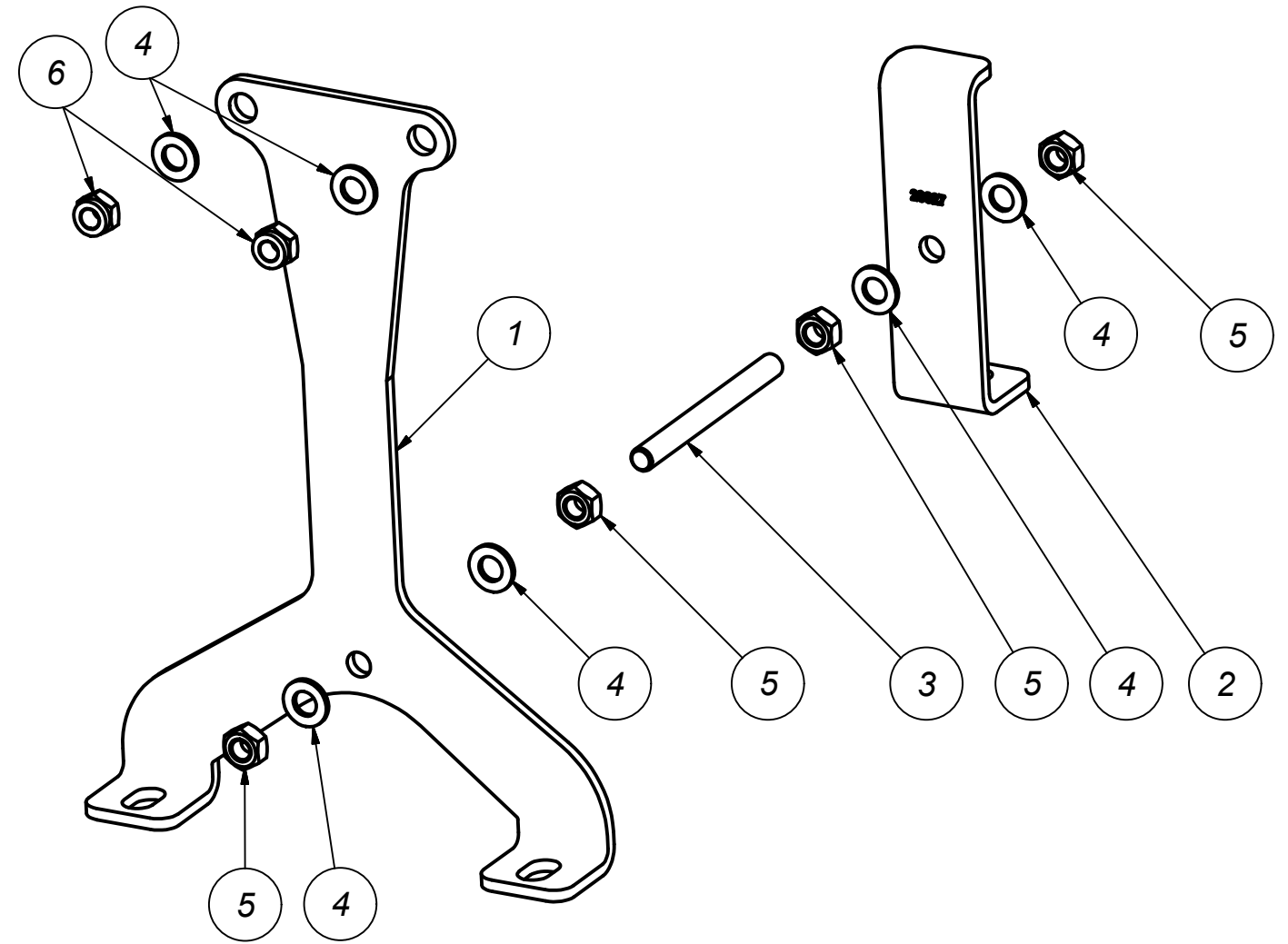
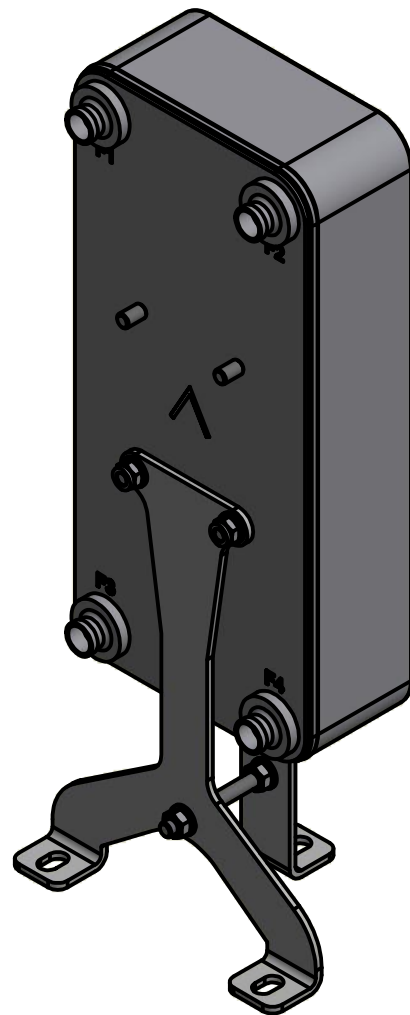
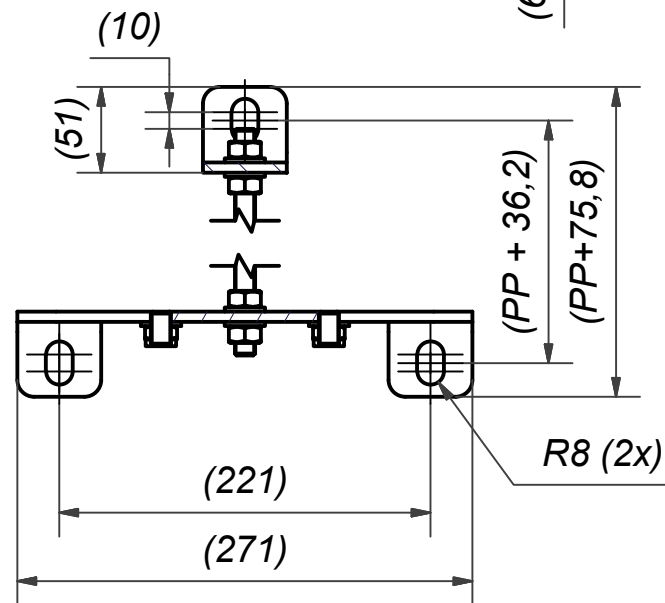
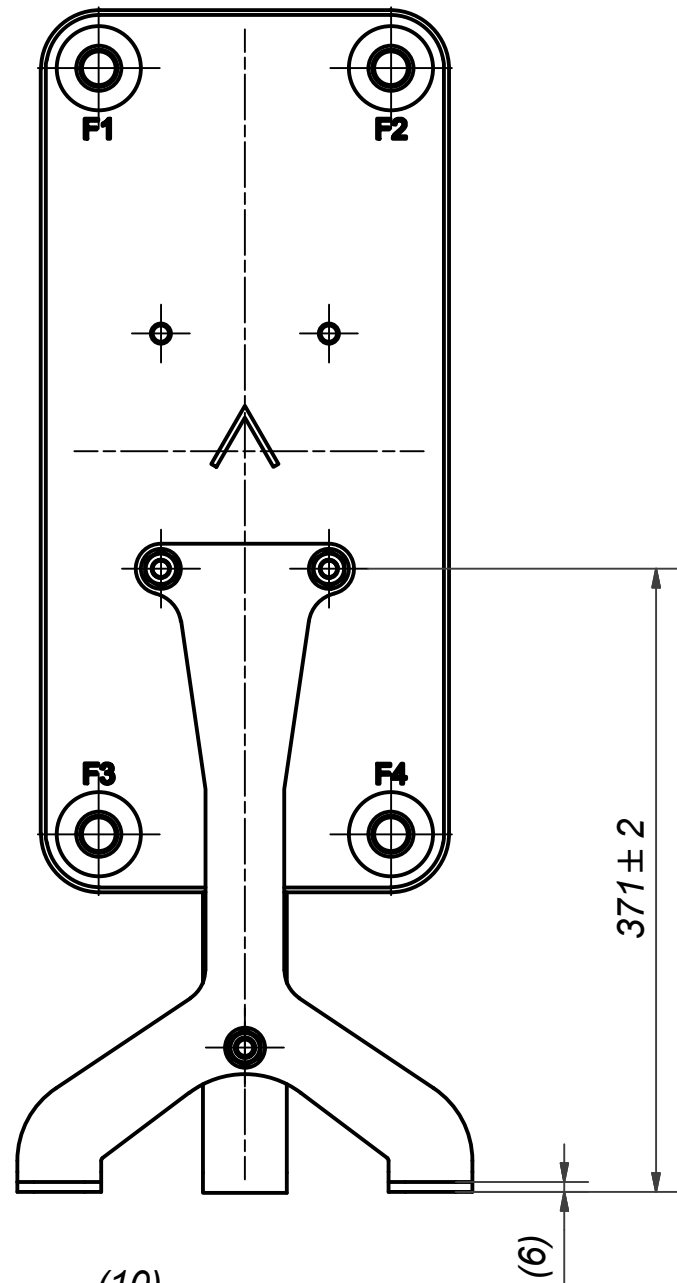

NOTE 3: LENGTH OF THREADED BAR ACCORDIN DRAWING.
NOTE 2: FOR B57 WITH STD Conn. STUD BOLT 21235 IS REQUIRED.
NOTE 1: REQUIRES STUD BOLT 21118, 21120 (B45, B50, B56, B200, 120T, 320LT, 320HT).

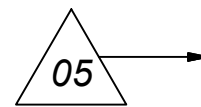

ITEM	QTY	TITLE	Drawing No.
6	2	R-LOCKNUT M12 A2, 45523	DIN 985 - M12
5	4	NUT M12 M6M 8M FZB, 45889	DIN 934 - M12
4	6	WASHER ART. NO 45524	13x24x2.5
3	1	THREADED BAR M12	CC000168
2	1	B35/45/50/57 SUPPORT LEG. ART.NO.28027	CC000165
1	1	B45/50/57 SUPPORT LEG, ART.NO. 28029	CC000167

Drawn	Checked	Approved	Created Date	General geometrical tolerancing ISO 2768	General surface finish R_a	Scale	Paper size
lathe	PDM	PDM	2005-07-27			-	A3



Title				
B120/50/57 SUPPORT LEG				
Article / Tool number	Design Type	Drawing number	Revision	Sheet
0	CG	CG450025	05	1 (1)

Rev No	Alteration	Date	Checked	Approved
11	Add chamfer for copper clogging refer to RD101676 ECN-000160	2021-06-09	CNFRG	PDM

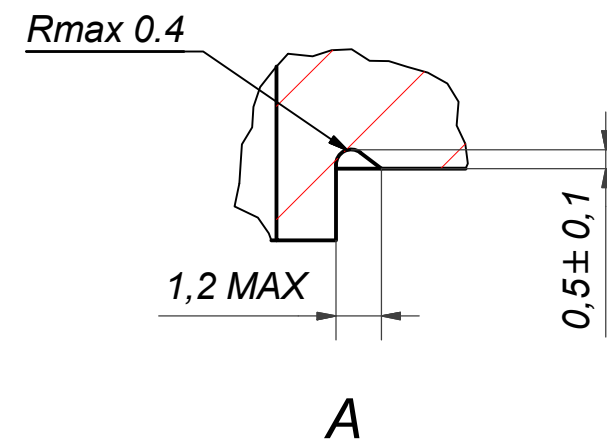
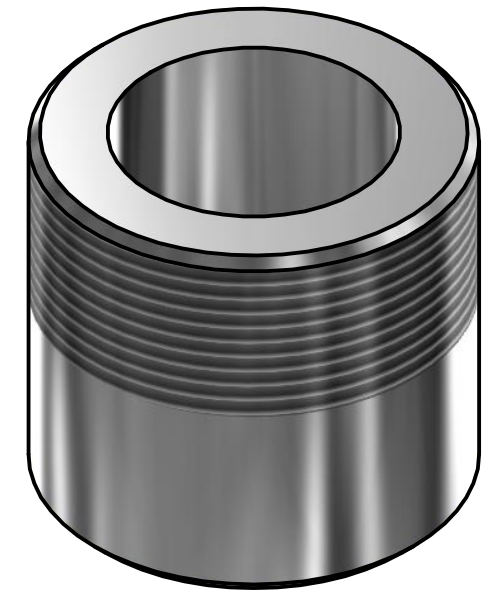
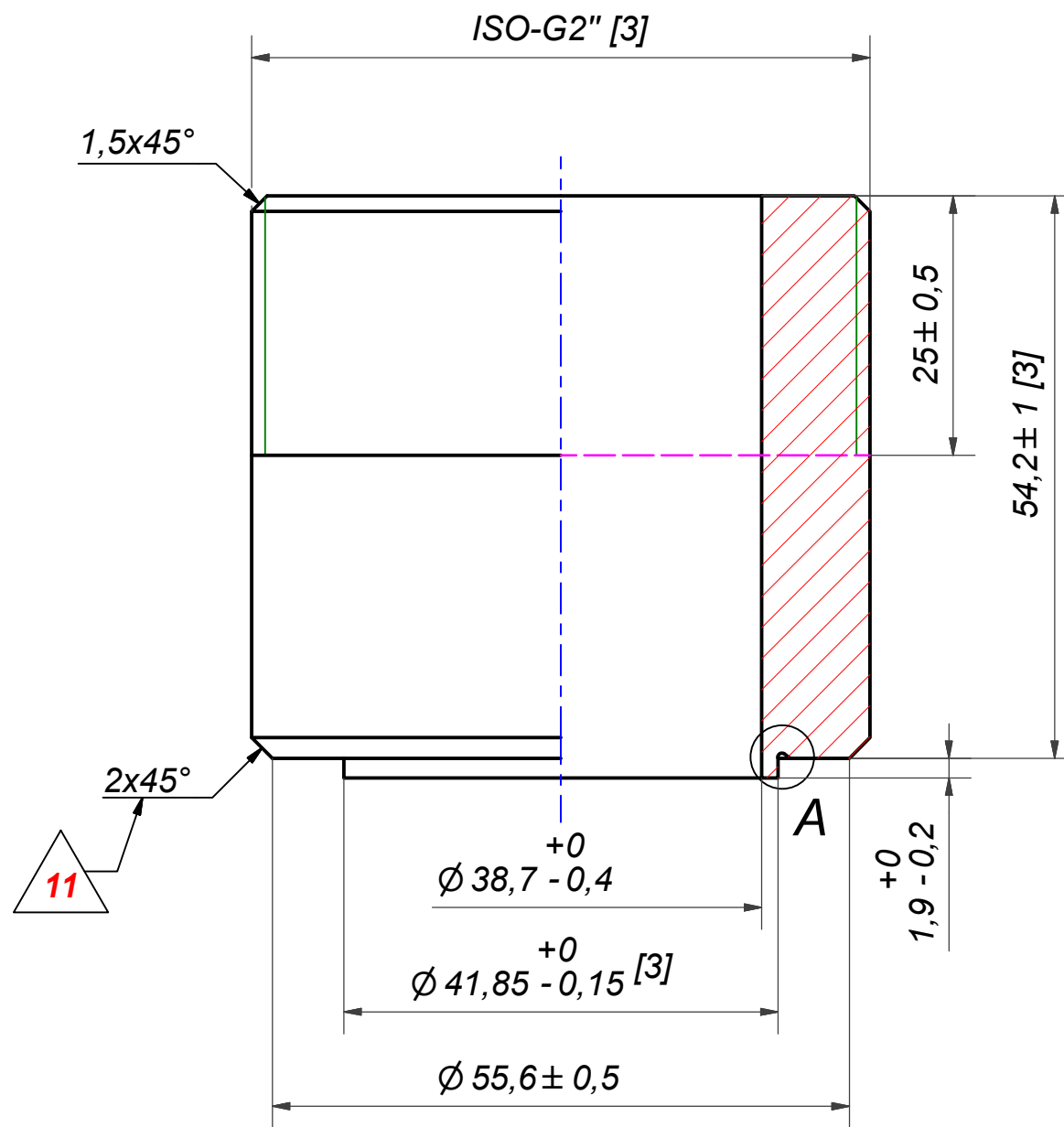

NOTE 1: DEBURR SHARP EDGES; MAX 0.4

NOTE 2: [3]-CRITICAL/SPECIAL CHARACTERISTICS TO BE FOLLOWED

© Company Confidential, Property of SWEP International AB

AXINTRA
ÉCHANGEURS THERMIQUES

ACCORDING TO MQS
MATERIAL

Drawn	Checked	Approved	Created Date	General geometrical tolerancing ISO 2768:	General surface finish R_a :	Scale	Paper size
miguser	PDM	PDM	1990-09-08	mK	3.2	-	A3
SWEP A DOVER COMPANY			Title: ISO-G 2"				
Article number		Design Type	Drawing number	Revision	Sheet		
		CD	CD000041	11	1 (1)		