

# B35T

Le B35T est le produit idéal pour de nombreuses applications : chauffage urbain, récupération de chaleur, cogénération, refroidissement d'huile de transmission et de moteur. Il est le choix parfait pour bénéficier de transferts de chaleur efficaces et de faibles pertes de charges dans des systèmes de conduites jusqu'à 2 pouces et des débits d'eau jusqu'à 27 m<sup>3</sup>/h (118.8 gpm).



## Spécifications de base

|                              |  |
|------------------------------|--|
| Nombre de plaques max. (NoP) | 260  |
| Débit volumétrique max.      | 58 m <sup>3</sup> /h (255.37 gpm)                          |
| Volume du canal              | 0.18/0.18 dm <sup>3</sup> (0.0064/0.0064 ft <sup>3</sup> ) |
| Matières                     | Plaques en acier inoxydable 316, brasage cuivre            |
| Poids sans les connexions    | 6.96+(0.247*NoP) kg<br>15.35+(0.545*NoP) lb                |

## Les dimensions standard

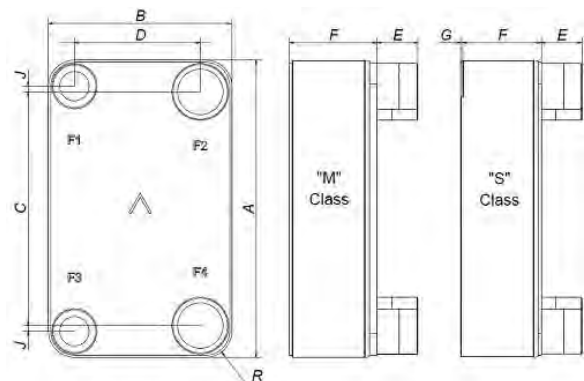

| #   | MM               | IN              |
|-----|------------------|-----------------|
| A   | 393              | 15.47           |
| B   | 243              | 9.57            |
| C   | 309              | 12.17           |
| D   | 159              | 6.26            |
| F   | 10.00+2.26*(NoP) | 0.39+0.09*(NoP) |
| G   | 4                | 0.16            |
| R   | 35               | 1.38            |
| E_1 | 27               | 1.06            |

## PED pression / température

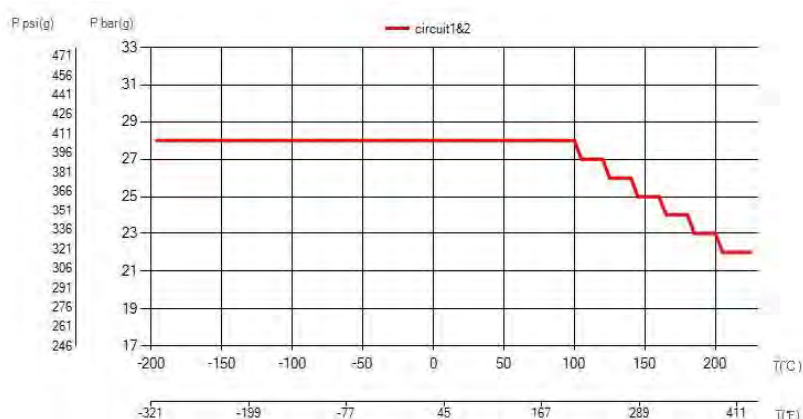

# AXINTRA

ÉCHANGEURS THERMIQUES

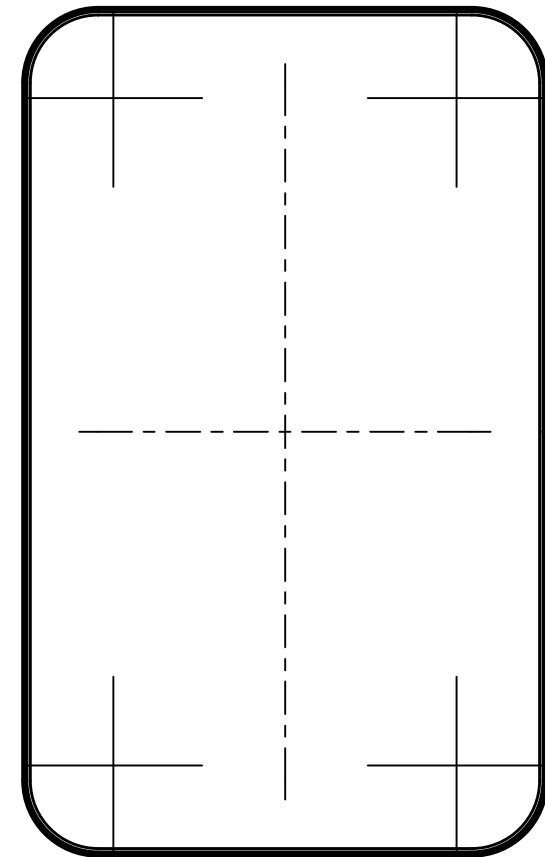
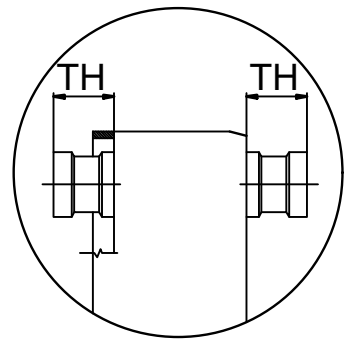
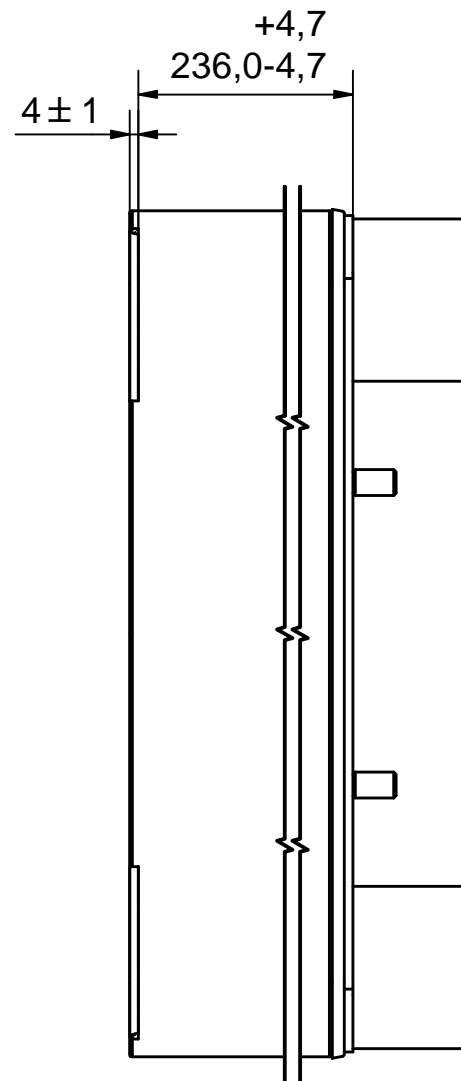
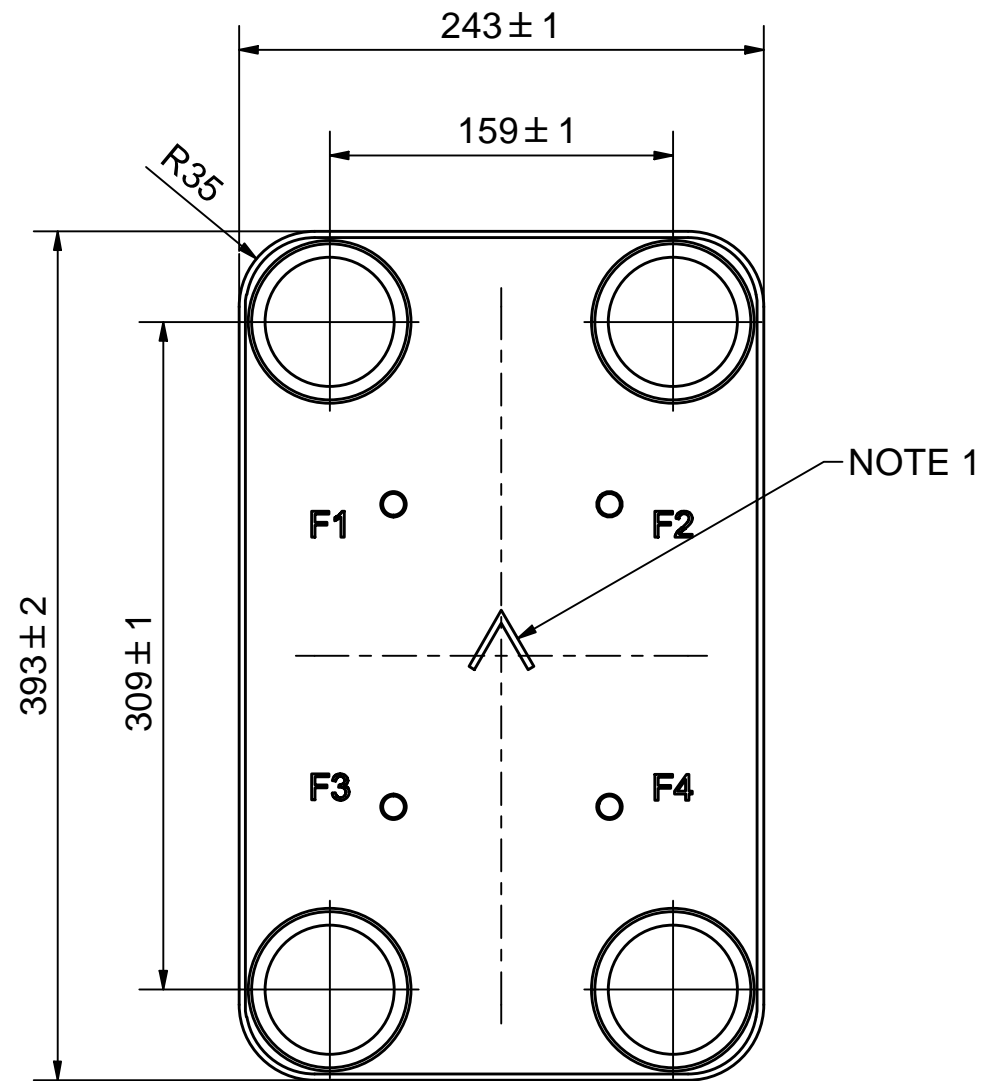

**AXINTRA**  
ÉCHANGEURS THERMIQUES

NOTE 1 ALTERNATE MARKING: STICKER OR STAMP

|    |       |                            |            |
|----|-------|----------------------------|------------|
| F4 | 45311 | ISO-G 2 1/2 A, TH = 54,2   | CD000051   |
| F3 | 45311 | ISO-G 2 1/2 A, TH = 54,2   | CD000051   |
| F2 | 45311 | ISO-G 2 1/2 A, TH = 54,2   | CD000051   |
| F1 | 45311 | ISO-G 2 1/2 A, TH = 54,2   | CD000051   |
| F  | 21112 | B35 BOLT LOC F 4x C140x100 | CG350001_1 |

| Pos | Article No | Title / Denomination, code, material, dimension etc | Drawing No./ref | Pos | Article No | Title / Denomination, code, material, dimension etc | Drawing No./ref |
|-----|------------|---|-----------------|-----|------------|---|-----------------|
|-----|------------|---|-----------------|-----|------------|---|-----------------|

|       |                              |                |                      |
|-------|------------------------------|----------------|----------------------|
| Title |                              | B35TM4/1P-SC-S |                      |
|       | Created Date                 | 2024-07-16     | Created By           |
|       | Article/Configuration number | 16106-100      | Drawing number       |
|       |                              |                | AU                   |
|       |                              |                | AU00053486_16106-100 |

| Rev No. | Alteration          | Date       | Checked | Approved |
|---------|---------------------|------------|---------|----------|
| 2       | REDRAWN IN INVENTOR | 2004/12/10 | PDM     | PDM      |

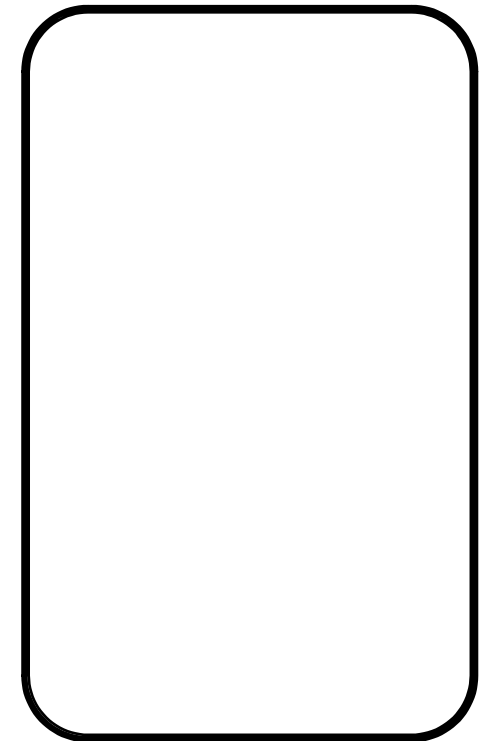
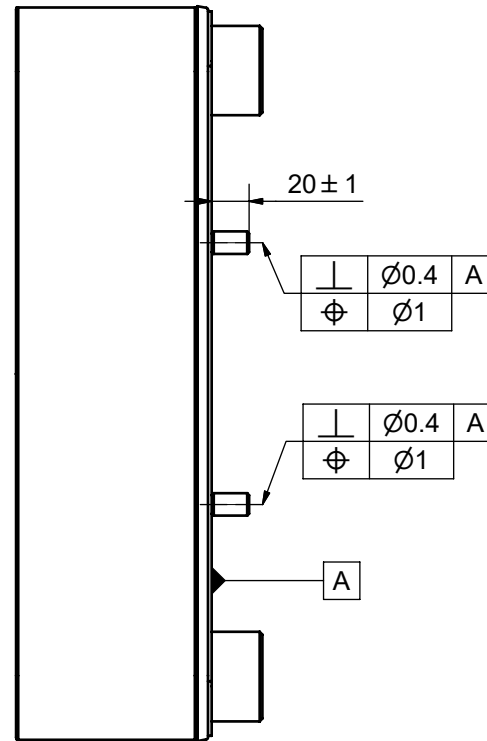
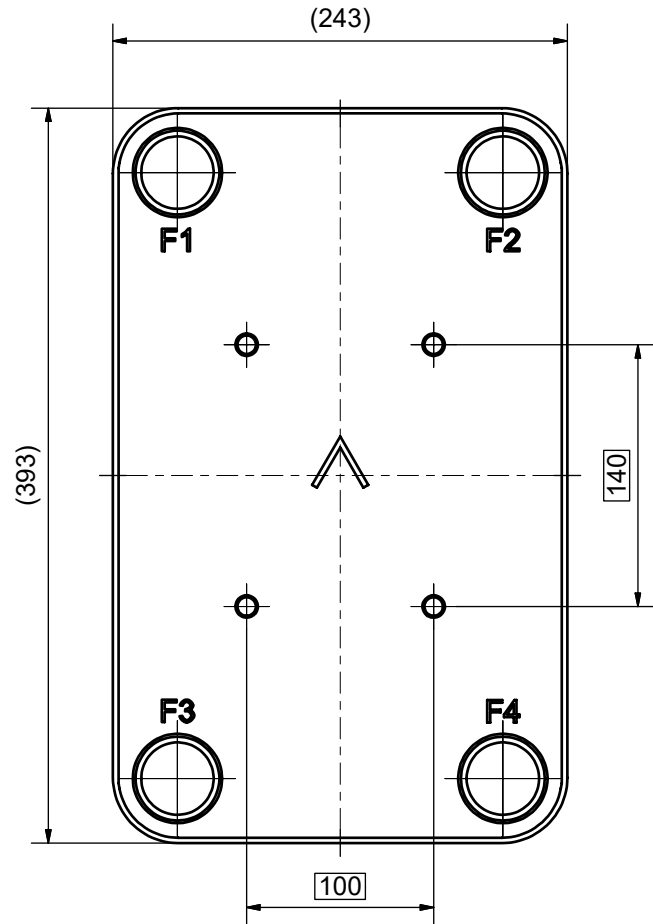

© Company Confidential, Property of SWEP International AB

|       |         |                                    |                            |  |                              |             |
|-------|---------|------------------------------------|----------------------------|--|------------------------------|-------------|
| 1     | 4       | STUD BOLT M12 x 20, ART. NO. 45095 |                            |  |                              | M12 x 20    |
| ITE   | QTY     | DESCRIPTION                        |                            |  |                              | Drawing No. |
| Drawn | Checked | Approved                           | Created Date               | General geometrical tolerancing ISO 2768 | General surface finish $R_a$ | Scale       |
| JA    | PDM     | PDM                                | 2004/10/12                 | m  | 3.2                          | 1:1         |
|       |         |                                    | Title                      |  |                              |             |
|       |         |                                    | B35 BOLT LOC F 4x C140x100 |  |                              |             |
|       |         | Article number                     | Drawing number             | Revision                                 | Sheet                        |             |
|       |         | 21112                              | CG350001                   | 2  | 1 (1)                        |             |

| Rev No | Alteration   | Date       | Checked | Approved |
|--------|--|------------|---------|----------|
| 09     | ECN-000161: Groove (Detail Z), [3] for crit. char., no zero mark | 2021-01-28 | SKGL    | VP       |

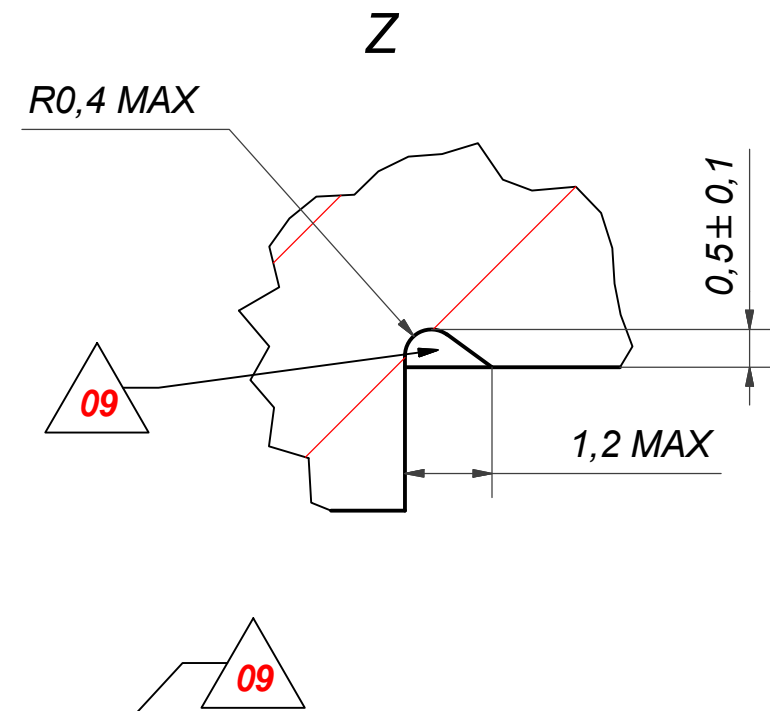
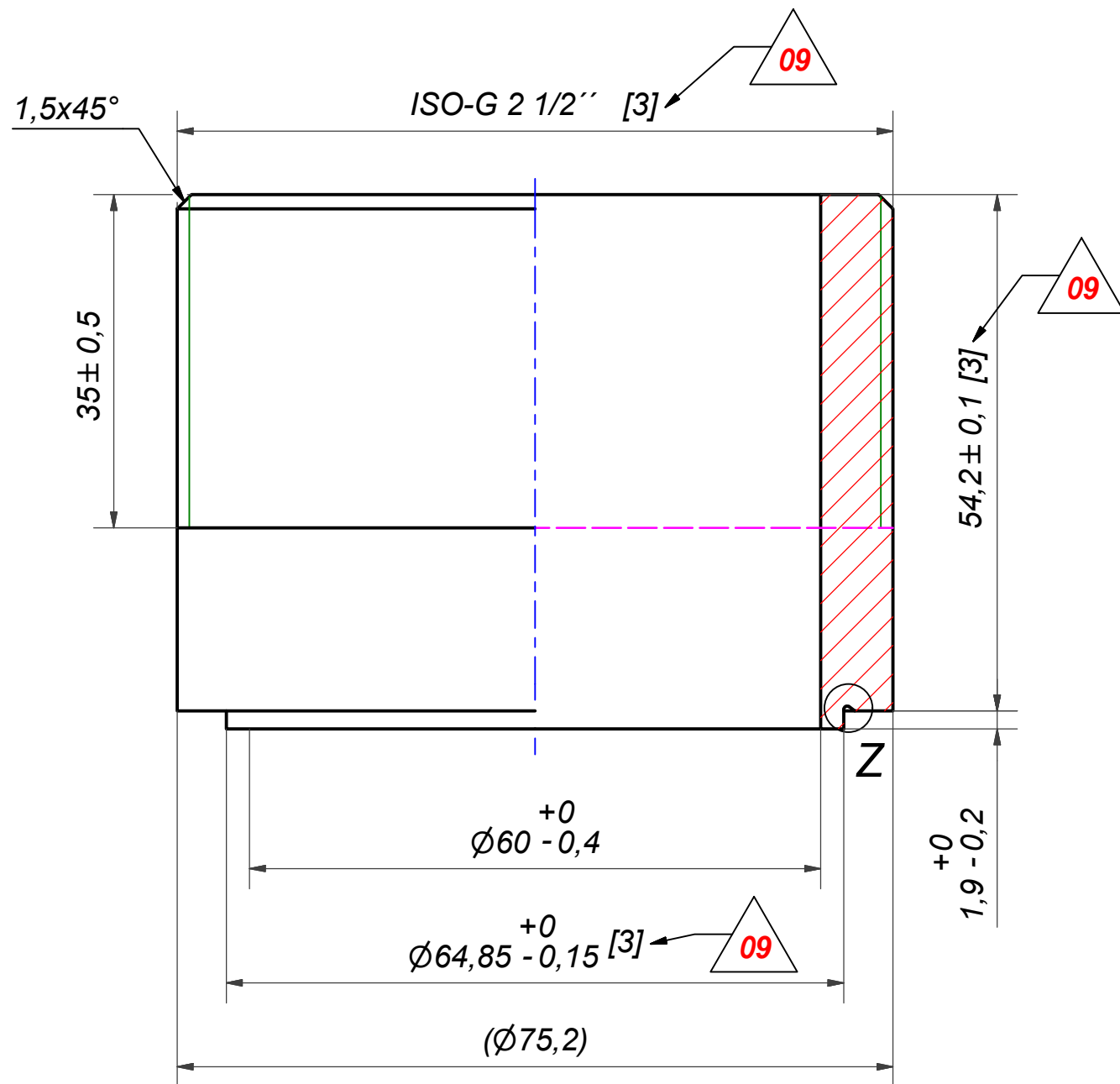

**NOTE 2: [3] - CRITICAL/SPECIAL CHARACTERISTIC TO BE FOLLOWED**  
**NOTE 1: DEBURR SHARP EDGES; MAX 0.4**

ACCORDING TO MQS  
MATERIAL

|                  |               |                |                            |  |                                       |                |                |                  |
|------------------|---------------|----------------|----------------------------|--|---------------------------------------|----------------|----------------|------------------|
| Drawn<br>miguser | Checked<br>TP | Approved<br>VP | Created Date<br>1991-03-15 | General geometrical tolerancing ISO 2768:<br>m | General surface finish $R_a$ :<br>3.2 |                | Scale<br>-     | Paper size<br>A3 |
|                  |               |                | Title<br>ISO-G 2 1/2       |  |                                       |                |                |                  |
|                  |               |                | Article number<br>CD       | Design Type<br>CD                              | Drawing number<br>CD000051            | Revision<br>09 | Sheet<br>1 (1) |                  |